



Reliability and Performance

ToLEDo® Performer

The ToLEDo® Performer series is a direct retrofit solution to replace high-pressure mercury vapor lamps. It is a quick, safe and easy way to upgrade traditional HID installation to LED while keeping the initial investment low.

ToLEDo® Performer T-Series



Features

- Direct retrofit replacement for high-pressure mercury vapor lamps (HPMV)
- 50,000 hours average rated lifetime
- Up to 78% energy saving compared to the standard high-pressure mercury vapor lamps
- Mercury-free solution
- Lower maintenance cost
- High lumen efficacy - up to 131lm/W
- Dual operating mode – compatible with HPMV magnetic ballast and also, suitable for AC direct mains 100-240V operation
- High surge voltage protection: 4kV
- Suitable for both open and enclosed luminaires
- Wide light distribution
- High switching cycles – 200,000X
- High colour rendering – CRI80
- Minimum and maximum operating temperature: -30°C to 50°C

Product information

Code	Description	Voltage (V)	Power (W)	Luminous Flux (lm)	Efficiency	Colour Temp (K)	Base	Finish	Life (h)	Dimmable (Y/N)	Energy Class	Packaging Qty
ToLEDo® Performer T60 Non-Dimmable												
0028369	ToLEDo Performer T60 2300lm 840 E27 SL	100-240	18	2300	128	4000	E27	Clear	50,000	N	E	6
0028425	ToLEDo Performer T60 3100lm 830 E27 SL	100-240	27	3100	115	3000	E27	Clear	50,000	N	E	6
0028370	ToLEDo Performer T60 3400lm 840 E27 SL	100-240	27	3400	126	4000	E27	Clear	50,000	N	E	6
ToLEDo® Performer T85 Non-Dimmable												
0028426	ToLEDo Performer T85 4100lm 830 E27 SL	100-240	36	4100	114	3000	E27	Clear	50,000	N	E	6
0028371	ToLEDo Performer T85 4500lm 840 E27 SL	100-240	36	4500	125	4000	E27	Clear	50,000	N	E	6
0028427	ToLEDo Performer T85 6100lm 830 E40 SL	100-240	54	6100	113	3000	E27	Clear	50,000	N	E	6
0028373	ToLEDo Performer T85 6800lm 840 E40 SL	100-240	54	6800	126	4000	E27	Clear	50,000	N	E	6
ToLEDo® Performer T130 Non-Dimmable												
0028428	ToLEDo Performer T130 V2 9500lm 830 E40 SL	120-240	80	9500	119	3000	E40	Clear	50,000	N	E	4
0028379	ToLEDo Performer T130 V2 10500lm 840 E40 SL	120-240	80	10500	131	4000	E40	Clear	50,000	N	E	4
0028429	ToLEDo Performer T130 V2 12000lm 830 E40 SL	120-240	100	12000	120	3000	E40	Clear	50,000	N	E	4
0028380	ToLEDo Performer T130 V2 13000lm 840 E40 SL	120-240	100	13000	130	4000	E40	Clear	50,000	N	E	4
0028381	ToLEDo Performer T130 V2 15000lm 840 E40 SL	120-240	120	15000	125	3000	E40	Clear	50,000	N	E	4

Images



T60 2300lm* T60 3400lm T85 4500lm T85 6800lm T130 10500lm T130 13000lm T130 15000lm

*Made to order

Dimensions (mm)

	Diameter (Ø)	Height (H)	Net Weight (Kg)
2300lm	60	150	0.25
3100lm/3400lm	60	175	0.31
4100lm/4500lm	85	204	0.63
6100lm/6800lm	85	245	0.77
9500lm/10,500lm	130	250	1.33
12,000lm/13,000lm	130	265	1.45
15,000lm	130	286	1.58

ToLEDo® Performer H-Series



Features

- The ToLEDo® Performer H-Series is designed for replacing HID lamps for high-bay luminaires to maximise energy savings with wide light distribution
- Direct retrofit replacement for high-pressure mercury vapor lamps (HPMV)
- 50,000 hours average rated lifetime
- Up to 71% energy saving compared to the standard high-pressure mercury vapor lamps
- Detachable 3.5mm jack plug microwave sensor allow to adjust hold-time and standby brightness level
- Mercury-free solution
- Lower maintenance cost
- High lumen efficacy - up to 135lm/W
- Dual operating mode – compatible with HPMV magnetic ballast and also, suitable for AC direct mains 220-240V operation
- Up and down light distribution
- High surge voltage protection: 4kV
- Suitable for both open and enclosed luminaires.
- Wide light distribution.
- High switching cycles – 200,000X
- High colour rendering – CRI80
- Minimum and maximum operating temperature: -30°C to 50°C

Product information

Code	Description	Voltage (V)	Power (W)	Luminous Flux (lm)	Efficiency	Colour Temp (K)	Base	Finish	Life (h)	Dimmable (Y/N)	Energy Class	Packaging Qty
ToLEDo® Performer H200												
0028377	ToLEDo Performer H200 10500lm 840 E40 SL	220-240	80	10500	131	4000	E40	Clear	50,000	N	E	4
ToLEDo® Performer H230												
0028378	ToLEDo Performer H230 15500lm 840 E40 SL	220-240	115	15500	135	4000	E40	Clear	50,000	N	E	4

* Preset dimming - only when used with microwave sensor

Images



H200 10,500lm



H230 15,500lm

Dimensions (mm)

	Diameter (Ø)	Height (H)	Net Weight (Kg)
0028377	200	195	1.3
0028378	230	210	1.7

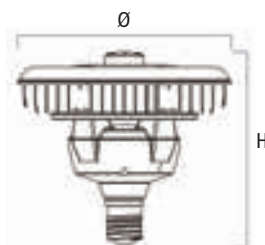

ToLEDo® Performer Microwave Sensor



Features

- The ToLEDo® Performer H-Series can be used with or without microwave sensor
- Easy to install and remove
- Detachable 3.5mm jack plug
- Maximum detection diameter - 12 meters
- Maximum detection height - 10 meters
- Hold time means full light output and not in standby mode.
- Hold time settings - 30 secs, 90 secs, 5 mins and 10 mins
- Standby brightness settings - 0% (zero light output), 20%, 40% and 60%
- Only works with ToLEDo® Performer H-Series

Images



Dimensions (mm)



ToLEDo® Performer Microwave Sensor Functions

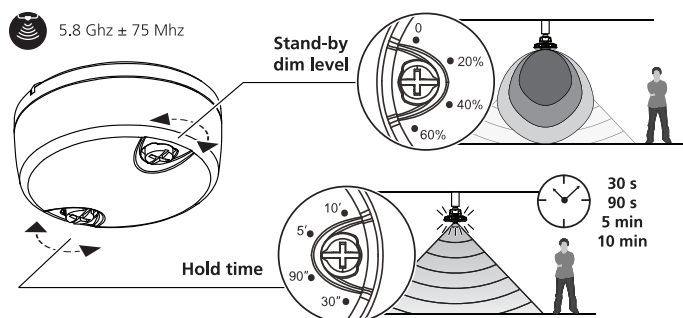

ToLEDo® Performer Microwave Sensor Range

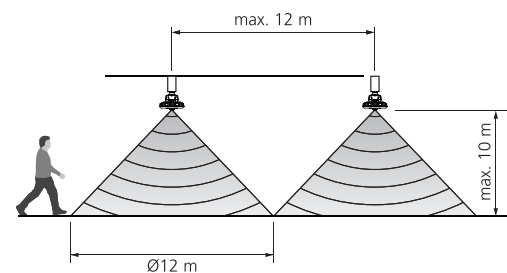

HPMV Magnetic Ballast (CCG) Compatibility Overview

Code	Description	50W HPMV Ballast	80W HPMV Ballast	125W HPMV Ballast
0028425	ToLEDo Performer T60 3100lm 830 E27 SL	✓	✓	✓
0028426	ToLEDo Performer T85 4100lm 830 E27 SL	✓	✓	✓
0028369	ToLEDo Performer T60 2300lm 840 E27 SL	✓	✓	✓
0028370	ToLEDo Performer T60 3400lm 840 E27 SL	✓	✓	✓
0028371	ToLEDo Performer T85 4500lm 840 E27 SL	✓	✓	✓

Code	Description	250W HPMV Ballast	400W HPMV Ballast
0028427	ToLEDo Performer T85 6100lm 830 E40 SL	✓	✓
0028428	ToLEDo Performer T130 V2 9500lm 830 E40 SL	✓	✓
0028429	ToLEDo Performer T130 V2 12000lm 830 E40 SL	✓	✓
0028373	ToLEDo Performer T85 6800lm 840 E40 SL	✓	✓
0028379	ToLEDo Performer T130 V2 10500lm 840 E40 SL	✓	✓
0028380	ToLEDo Performer T130 V2 13000lm 840 E40 SL	✓	✓
0028381	ToLEDo Performer T130 V2 15000lm 840 E40 SL	✓	✓
0028377	ToLEDo Performer H200 10500lm 840 E40 SL	✓	✓
0028378	ToLEDo Performer H230 15500lm 840 E40 SL	✓	✓



Installation instructions

ToLEDo® Performer

Magnetic / CCG ballast

⚙️ High Pressure Mercury Vapour (HPMV) Magnetic (CCG) ballast

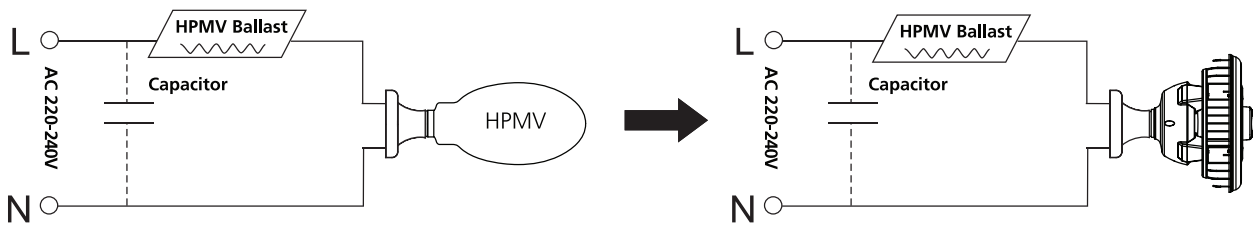

⚙️ High Pressure Mercury Vapour (HPMV) Magnetic (CCG) ballast

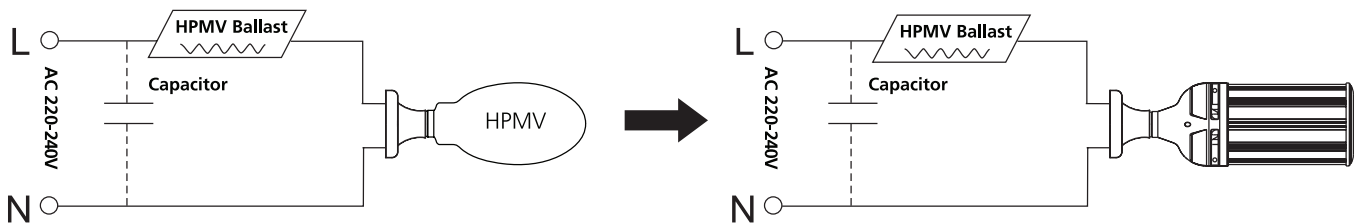

Direct Mains

⚙️ AC 100-240V / Direct Mains

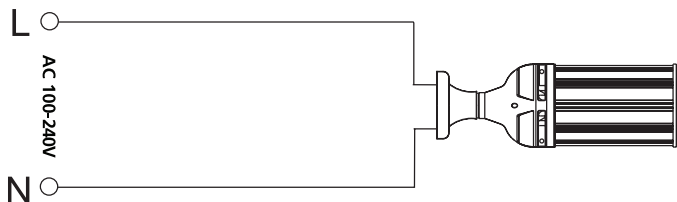

⚙️ AC 220-240V / Direct Mains

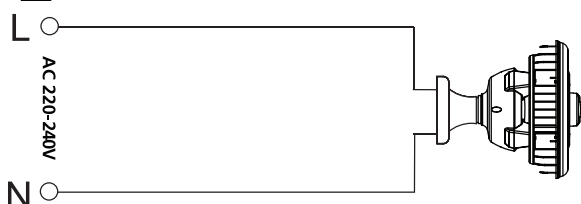

ToLEDo® Performer H200 / H230

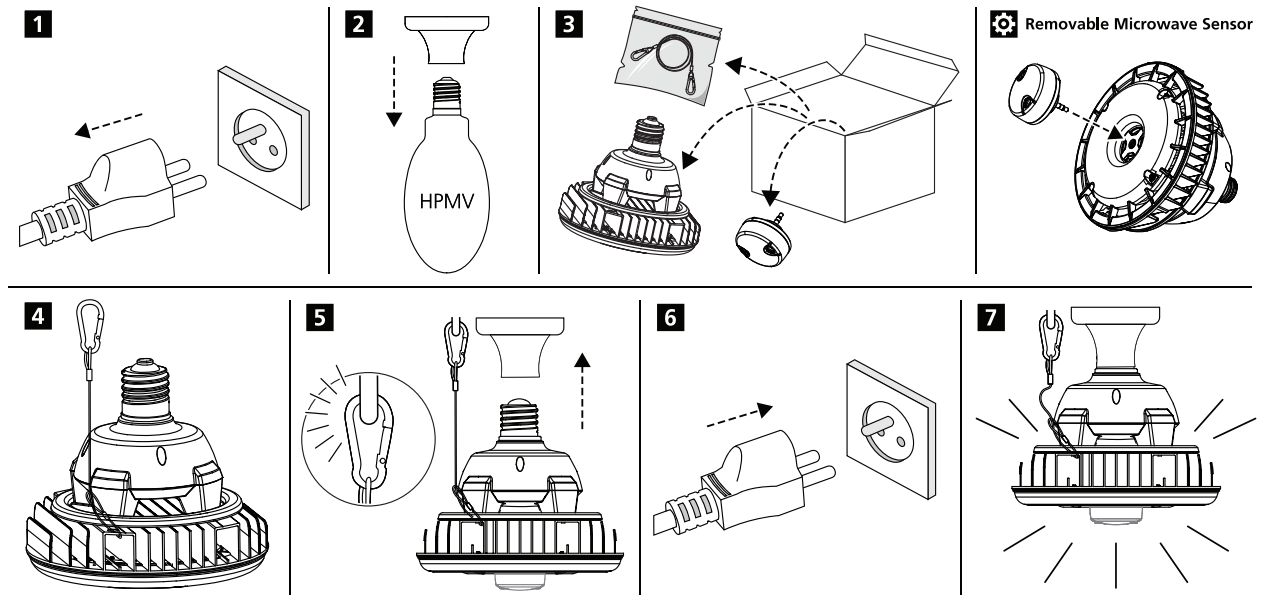

ToLEDo® Performer T60 / T85

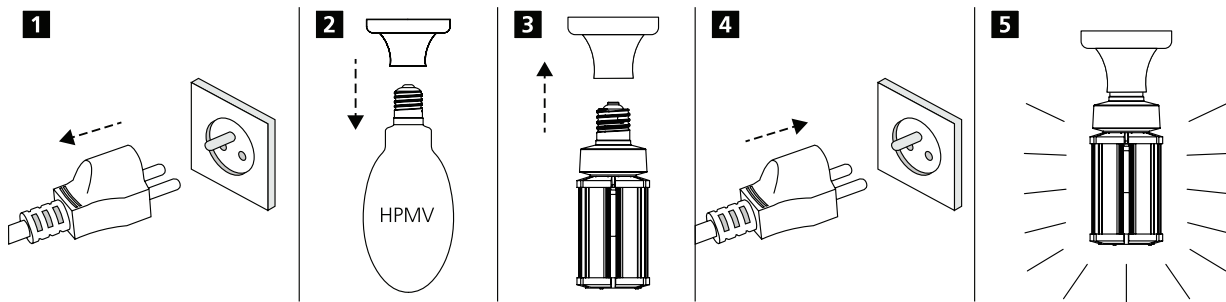

ToLEDo® Performer T130

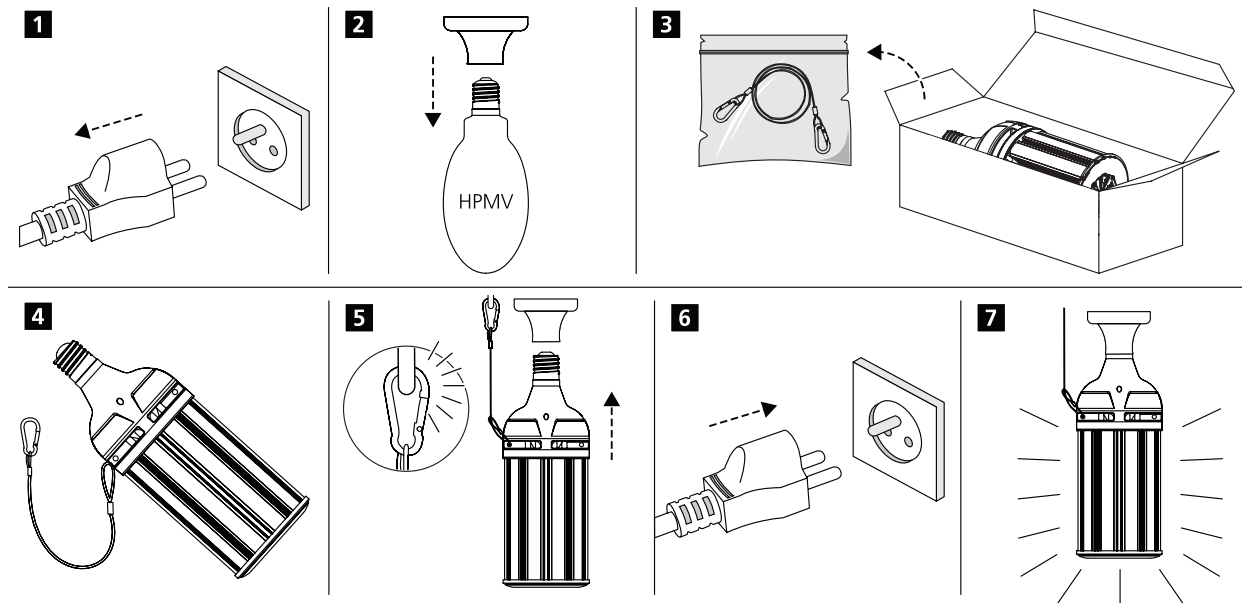

ToLEDo® Performer E-Series



Features

- Available in multiple output options from 2000lm to 10,000lm
- Offers two colour temperatures: warm white (3000K) and cool white (4000K)
- Designed in a classic white housing for a clean, professional appearance
- Available in energy-efficient classes B, C, and D
- Long-lasting performance with an average lifespan of 25,000 hours
- Uniform sizing across most models for consistent integration (height 183–230mm)
- Wide voltage compatibility (220–240V) ensures reliable performance in various installations
- Ideal for both indoor and outdoor use
- Outdoor applications require the lamp to be housed in luminaires/lamps sockets with suitable IP rating

Product information

Code	Description	Voltage (V)	Power (W)	Luminous Flux (lm)	Efficiency (lm/W)	Colour Temp (K)	IP rating	Housing Colour	Height (mm)	Width (mm)	Average Life (h)
ToLEDo® Performer Retro											
0030630	ToLEDo Performer Retro E 2000LM E27 830 SL	220-240	13	2000	154	3000	IP65	White	180	75	25,000
0030631	ToLEDo Performer Retro E 2000LM E27 840 SL	220-240	13	2000	154	4000	IP65	White	180	75	25,000
0030632	ToLEDo Performer Retro E 2800LM E27 830 SL	220-240	18	2800	156	3000	IP65	White	180	75	25,000
0030633	ToLEDo Performer Retro E 3000LM E27 840 SL	220-240	18	3000	167	4000	IP65	White	180	75	25,000
0030634	ToLEDo Performer Retro E 3500LM E27 830 SL	220-240	24	3500	146	3000	IP65	White	199	75	25,000
0030635	ToLEDo Performer Retro E 4000LM E27 840 SL	220-240	28	4000	143	4000	IP65	White	199	75	25,000
0030636	ToLEDo Performer Retro E 5500LM E40 830 SL	220-240	36	5500	153	3000	IP65	White	230	90	25,000
0030637	ToLEDo Performer Retro E 6000LM E40 840 SL	220-240	36	6000	167	4000	IP65	White	230	90	25,000
0030638	ToLEDo Performer Retro E 9000LM E40 830 SL	220-240	54	9000	167	3000	IP65	Clear	225	102	25,000
0030639	ToLEDo Performer Retro E 10000LM E40 840 SL	220-240	54	10000	185	4000	IP65	Clear	225	102	25,000

Images



0030630/0030631/
0030632/0030633



0030634/0030635



0030636/0030637



0030638/0030639

Installation instructions

ToLEDo® Performer

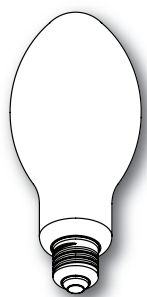

0030630
0030631
0030632
0030633

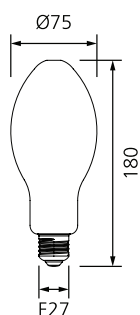

0030634
0030635

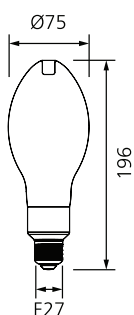

0030636
0030637

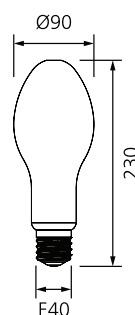

0030638
0030639

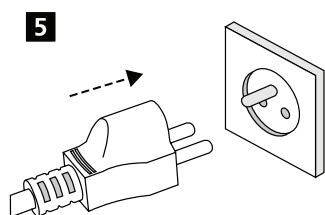
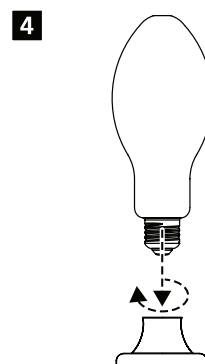
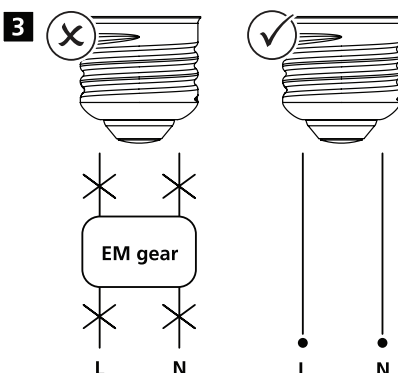
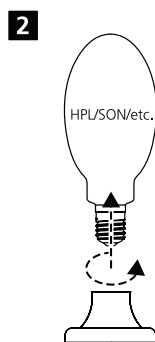
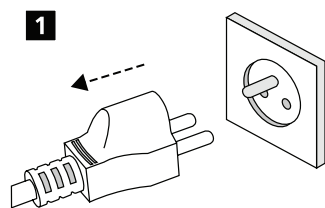
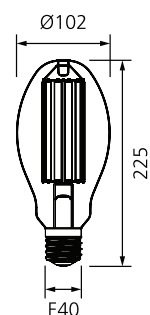

The product fulfills IP65 requirements except lamp cap, outdoor applications require the lamp to be used in luminaires with suitable IP rating.
Lamp cap needs to be installed in correct IP rated socket.

ToLEDo® Performer E-Series



Dimensions

Code	Diameter (mm)	Height (mm)
ToLEDo® Performer Retro		
0030630/0030631/0030632/0030633	180	75
0030634/0030635	199	75
0030636/0030637	230	90
0030638/0030639	225	102

Line Drawings

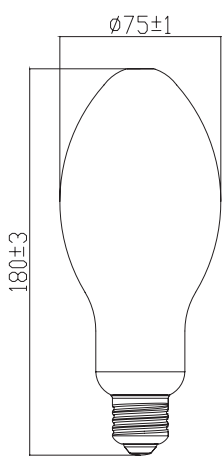

ToLEDO Performer 180x75 mm

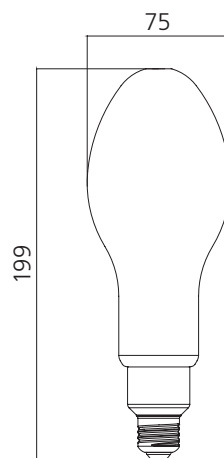

ToLEDO Performer 199x75mm

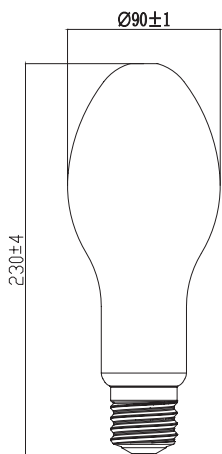

ToLEDo Performer 230x90 mm

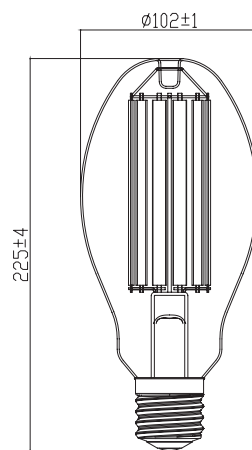

ToLEDo Performer 225x102 mm



SYLVANIA

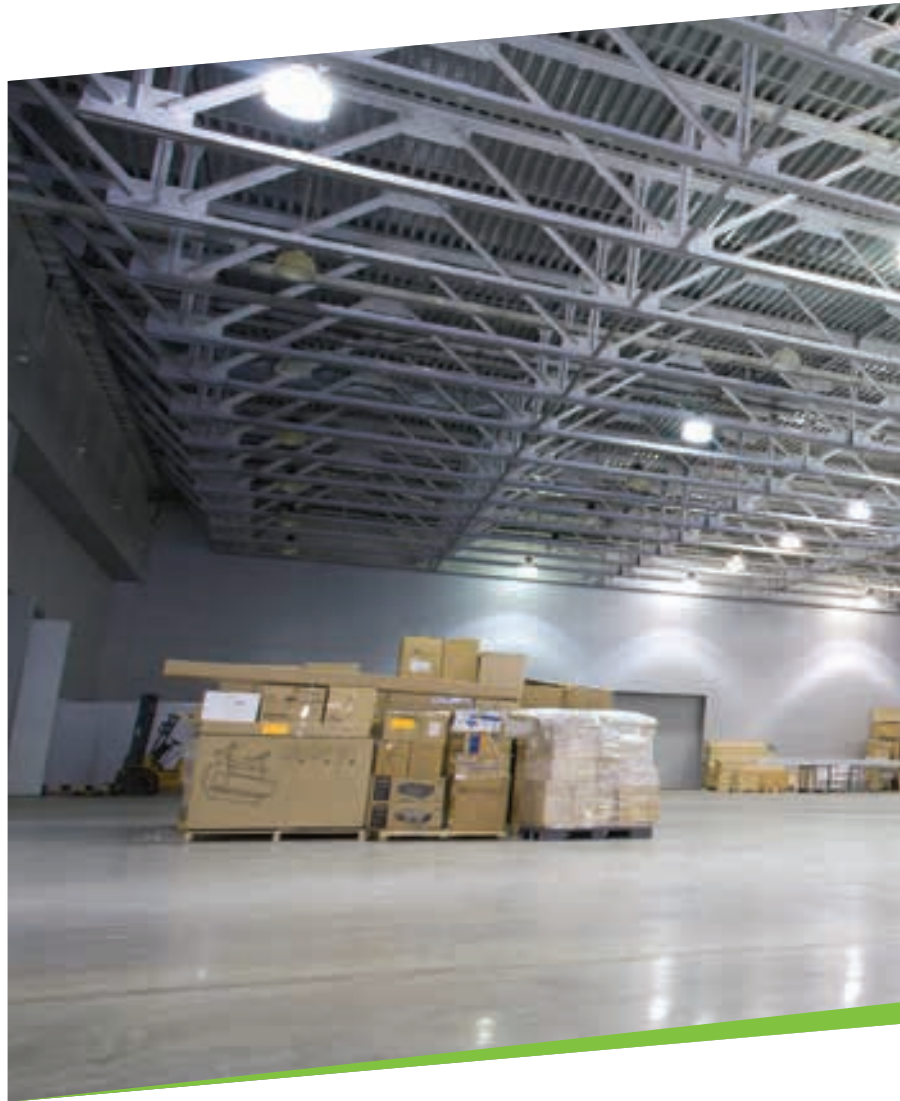

CE UK
CA

in f  

Although every effort has been made to ensure accuracy in the compilation of the technical detail within this publication, specifications and performance data are constantly changing. Current details should therefore be checked with Feilo Sylvania International Group Kft. Copyright Feilo Sylvania International Group Kft. November 2025.

sylvania-group.com

A Feilo Sylvania Company